

*L I F E I N N A T U R E*

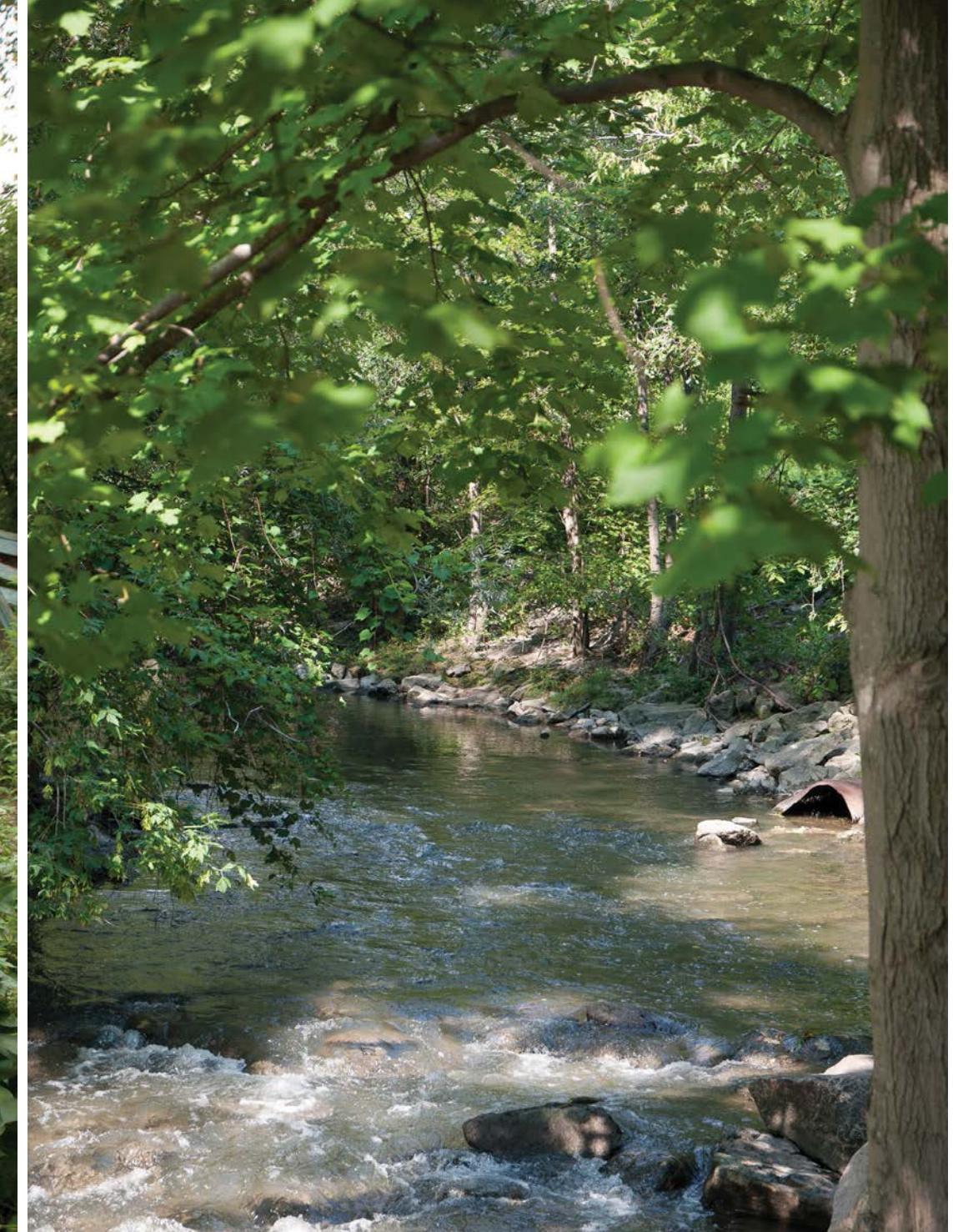



*NATURALLY BAYVIEW*



**NATURE AT ITS MOST NATURAL. THE ALLURE OF THE OUTDOORS.** WHETHER EXPLORING THE ABUNDANT TERRAIN OF THE BETTY SUTHERLAND TRAIL OR TAKING A MOMENT TO REFLECT AS THE DON RIVER REFLECTS BACK AT YOU, THE COMMUNITY OF BAYVIEW VILLAGE OFFERS ACRES AND ACRES OF LUSH LANDSCAPE TO EXPERIENCE, EXPLORE AND INSPIRE.





NATURALLY SCALA

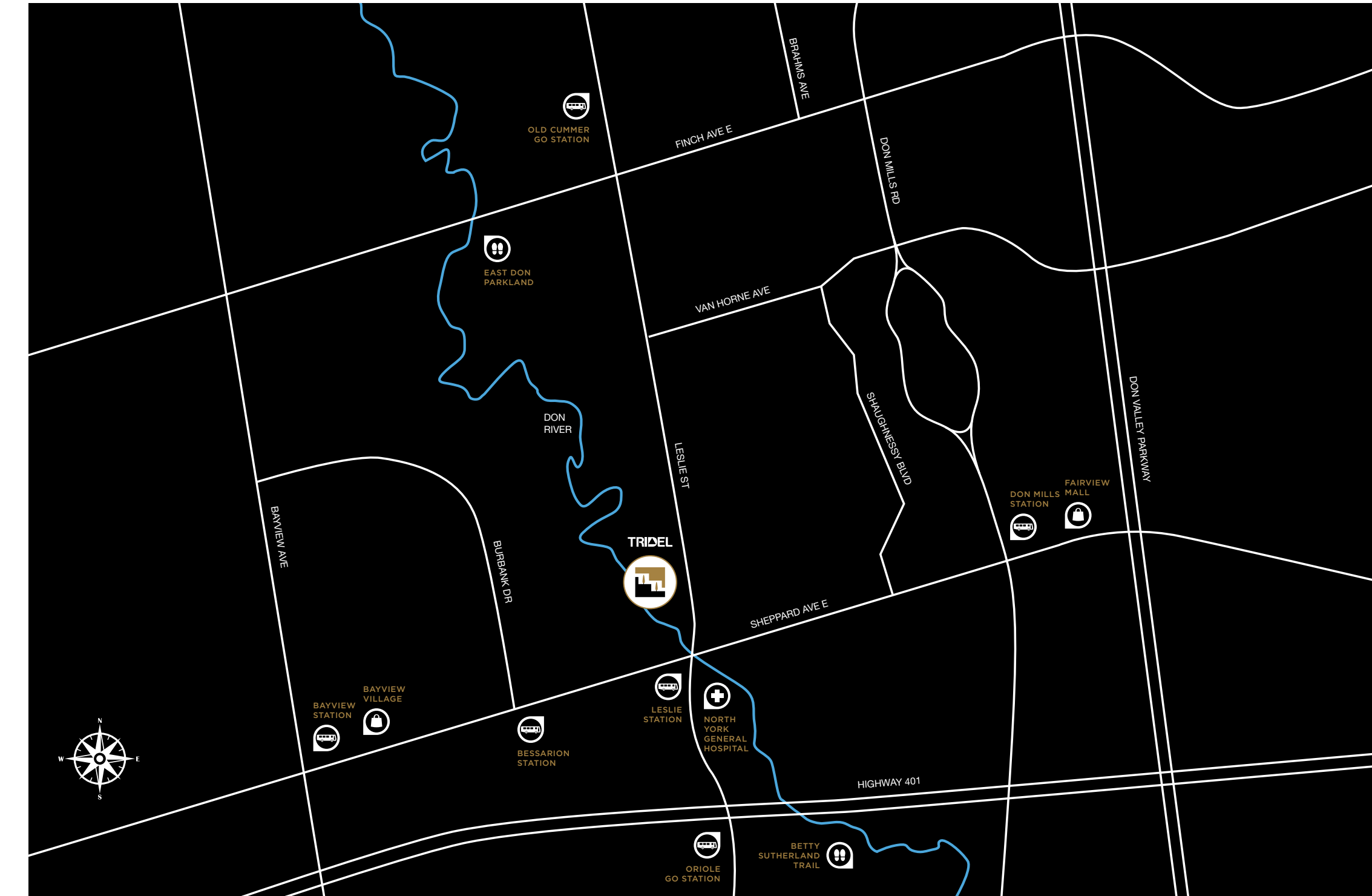

INTRODUCING A COMMUNITY IN STEP WITH THE LIFESTYLE YOU DESIRE. SCALA IS WHERE TRANQUILITY MEETS CITY LIVING. A LUXURIOUS CONDOMINIUM COMMUNITY SET AGAINST A NATURALLY LUSH RAVINE TERRAIN, SURROUNDED BY WINDING TRAILS AND VERDANT PARKLAND. ENHANCED BY AN INCREDIBLE COLLECTION OF LIFESTYLE AMENITIES, LIVING COMES NATURALLY AT SCALA.



EXTERIOR SITEPLAN

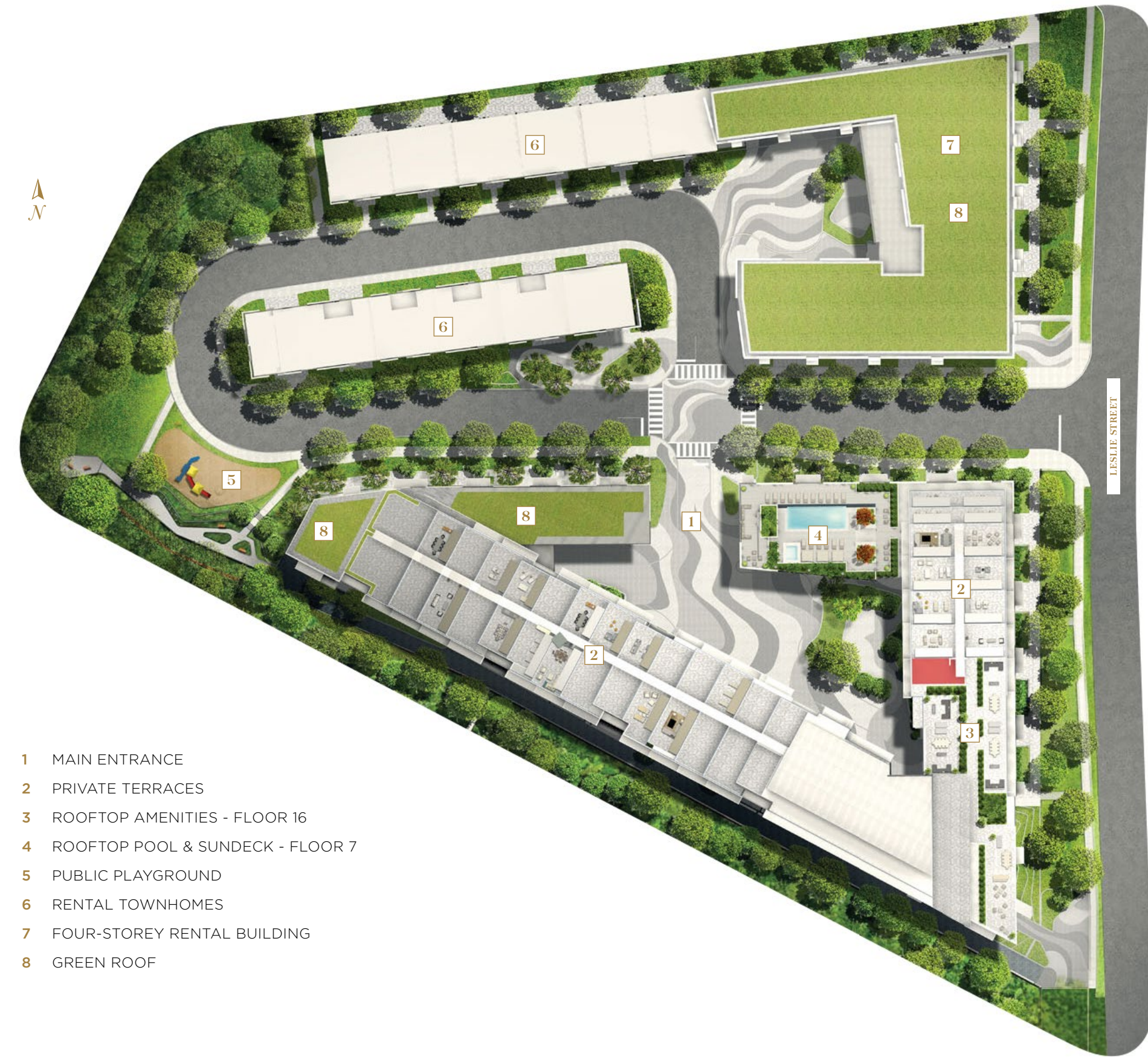

- 1 MAIN ENTRANCE
- 2 PRIVATE TERRACES
- 3 ROOFTOP AMENITIES - FLOOR 16
- 4 ROOFTOP POOL & SUNDECK - FLOOR 7
- 5 PUBLIC PLAYGROUND
- 6 RENTAL TOWNHOMES
- 7 FOUR-STOREY RENTAL BUILDING
- 8 GREEN ROOF

NATURALLY DESIGNED



FROM DINING ALFRESCO ON THE UPPER DECK TO SWIMMING LAPS AT THE OUTDOOR POOL, SCALA'S EXTERIOR AMENITIES ARE A BREATH OF FRESH AIR. CASCADING LEVELS OF LIFESTYLE CONVENIENCES WEAVE NATURALLY INTO THE SCALA TERRAIN. SPEND WEEKENDS LOUNGING POOLSIDE OR RELAXING IN THE HOT TUB. HOST A BARBEQUE OR A FRIENDLY YOGA RETREAT ON THE UPPER DECK. OR SIMPLY WARM UP ON COOL NIGHTS BY THE OUTDOOR FIRE PITS. THE GREAT OUTDOORS ARE MADE EVEN GRANDER AT SCALA.



EXTERIOR AMENITIES



ROOFTOP POOL & SUNDECK  
(FLOOR 7)

- 1 INFINITY POOL
- 2 HOT TUB
- 3 CABANAS
- 4 CHAISE LOUNGES
- 5 FIRE PIT LOUNGE
- 6 OUTDOOR YOGA AREA
- 7 DINING AND BARBEQUES
- 8 CASUAL LOUNGE



UPPER DECK AMENITY TERRACE  
(FLOOR 16)

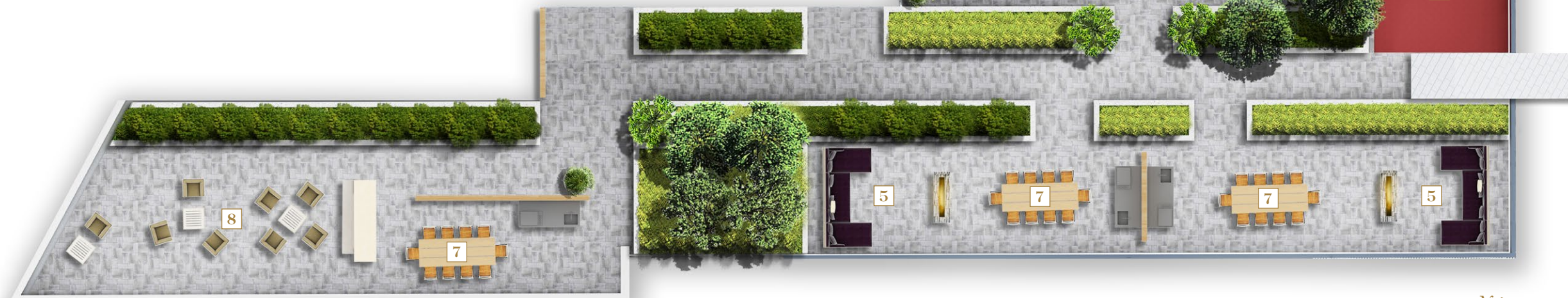

NATURALLY ACTIVE



FROM LEFT TO RIGHT: INFINITY POOL, UPPER DECK AMENITIES.



INTERIOR SITEPLAN

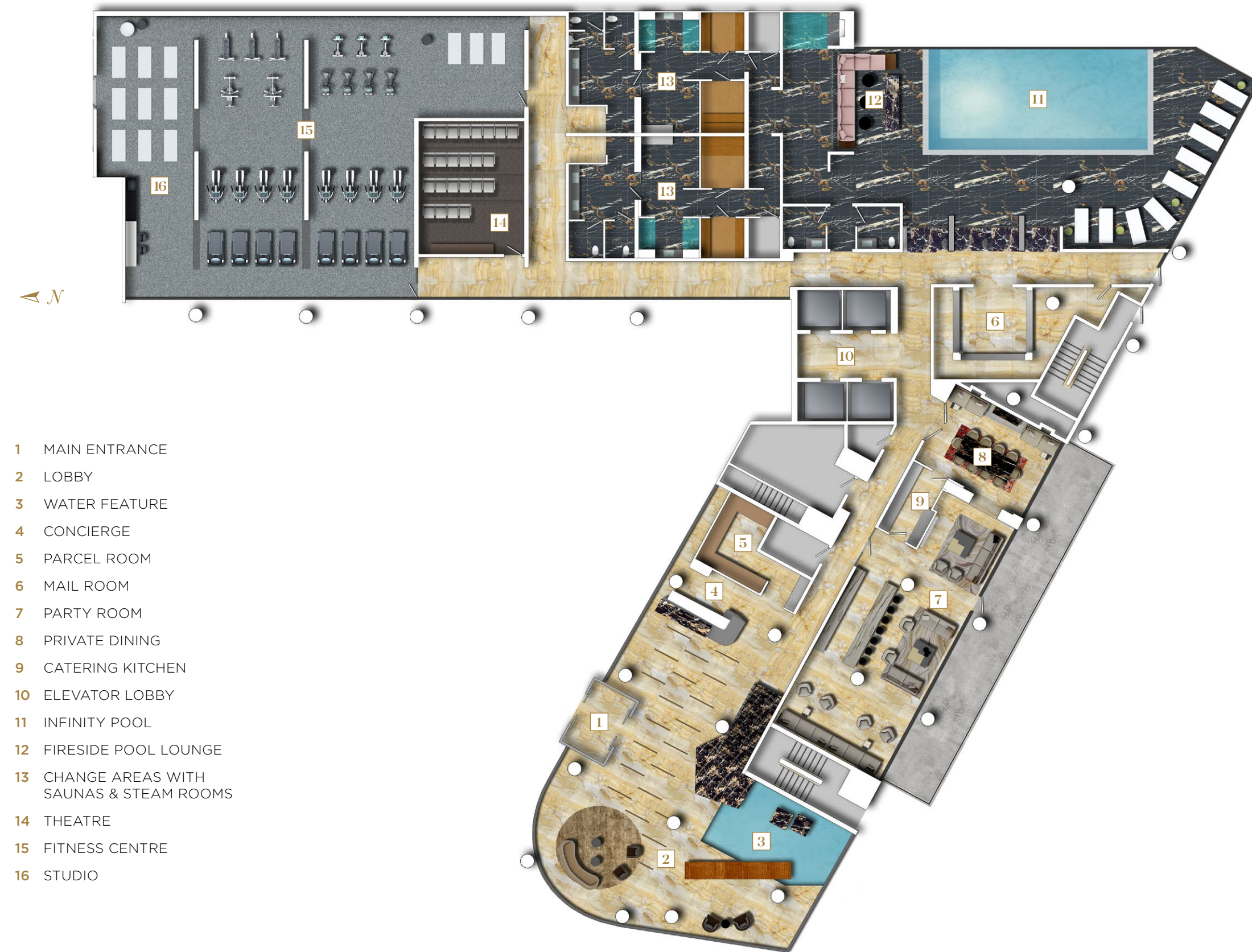

NATURALLY HOME



A HOME SHOULD FEEL LIKE A NATURAL EXTENSION OF YOUR LIFESTYLE. WHETHER THROUGH AN INVITING LOBBY THAT WELCOMES YOU HOME OR A FITNESS CENTRE THAT REINVIGORATES YOUR WORKOUT, SCALA OFFERS YOU AMENITIES THAT ELEVATE THE EVERY DAY. CELEBRATE WITH FAMILY AND FRIENDS IN THE LIVELY PARTY ROOM OR DIP YOUR TOES IN THE INFINITY ROOFTOP POOL, SOARING STOREYS HIGH ATOP SCALA.





LOBBY



FROM LEFT TO RIGHT: CONCIERGE & GRAND STAIRWAY, MAIN LOBBY & WATER FEATURE.





*INDOOR INFINITY POOL*



SUBMERGE YOURSELF IN AN AQUATIC ADVENTURE FOR THE SENSES.





FITNESS CENTRE



FROM LEFT TO RIGHT: CARDIO AREA, YOGA STUDIO, SPINNING AREA.





PARTY ROOM



KEEP THE CONVERSATION FLOWING IN A SPACE DESIGNED FOR SOCIALIZING.





*PRIVATE DINING*



TREAT YOUR GUESTS TO AN UPGRADE DINING EXPERIENCE.





## *Signature Terrace Collection*

COMMANDING VIEWS, UNFILTERED VISTAS, UNCOMPROMISED LIVING. THE SIGNATURE TERRACE COLLECTION OFFERS YOU A LIVING ENVIRONMENT THAT'S ONE WITH NATURE. EXPANSIVE TERRACE RETREATS EMBRACE THE OUTDOORS, PROVIDING YOU WITH A PRIVATE REFUGE AND PANORAMIC VIEWS OF BAYVIEW'S BEAUTY.